

On view at Dia Beacon

Click on the artists' last names embedded within the floor plan for more information.

Further explore Dia's collection with videos, behind-the-scenes content, and an interactive map on our mobile guide. Available now in [Bloomberg Connects](#), the free arts and culture app.

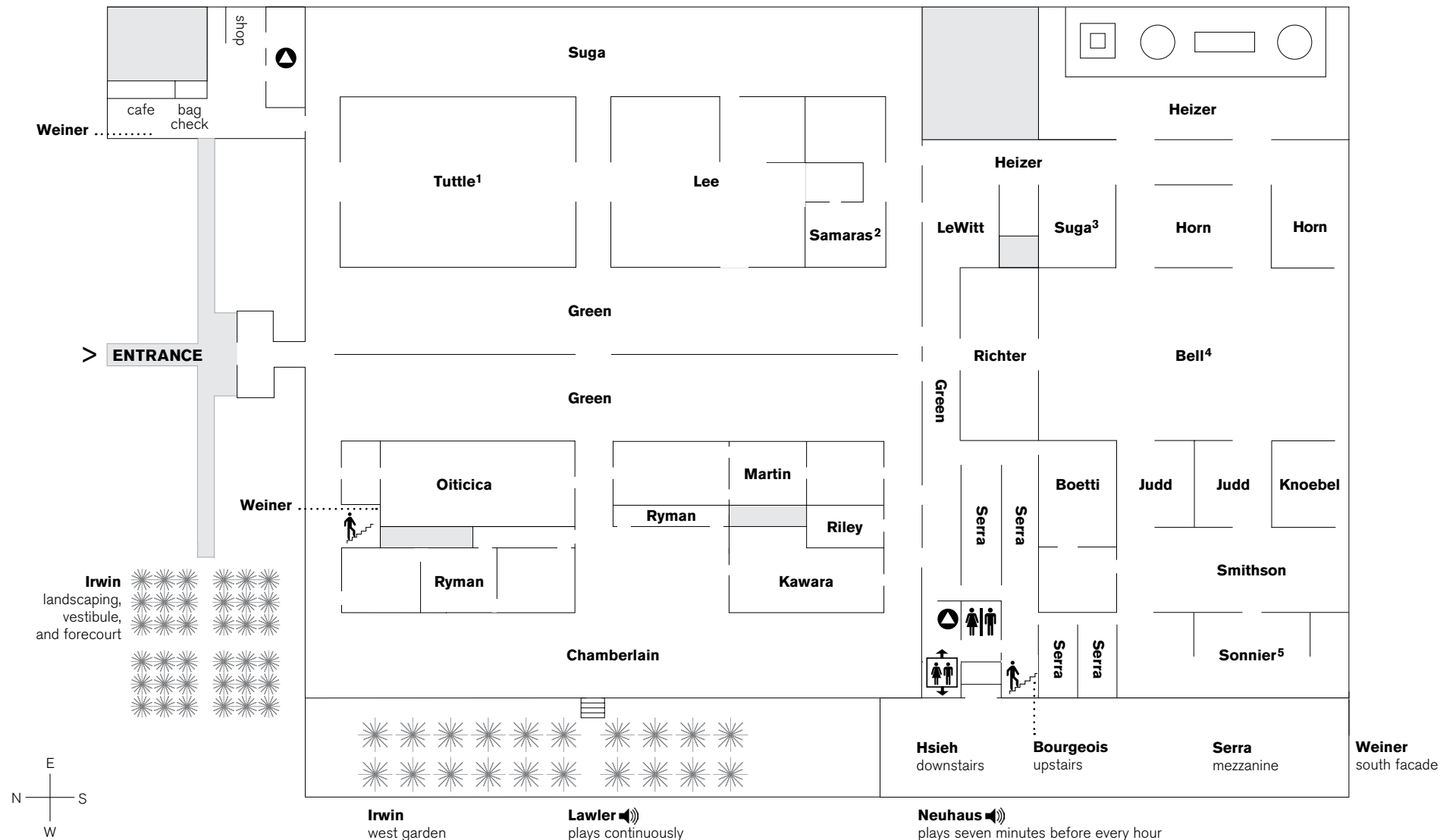

- | | |
|------------------|-----------------|
| Larry Bell | Agnes Martin |
| Alighiero Boetti | Max Neuhaus |
| Louise Bourgeois | Hélio Oiticica |
| John Chamberlain | Gerhard Richter |
| Renée Green | Bridget Riley |
| Michael Heizer | Robert Ryman |
| Roni Horn | Lucas Samaras |
| Tehching Hsieh | Richard Serra |
| Robert Irwin | Robert Smithson |
| Donald Judd | Keith Sonnier |
| On Kawara | Kishio Suga |
| Imi Knoebel | Richard Tuttle |
| Louise Lawler | Lee Ufan |
| Sol LeWitt | Lawrence Weiner |

Downstairs

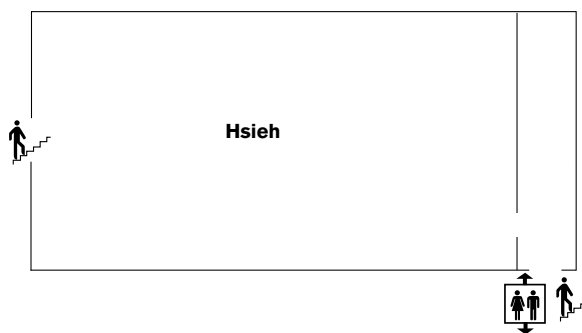

Please maintain a safe distance and do not touch the artwork.

For more information about the artists and artworks on view, including checklists, essays, and other resources, scan the QR codes in the galleries or visit [diaart.org](#).

1. *Richard Tuttle: Half-Light* opens July 31, 2026.
2. *Doorway* is fragile; entry is limited.
3. *Kishio Suga* opens August 7, 2026.
4. Please do not step on the carpets in this gallery. *Larry Bell* closes August 24; *Haegue Yang: Through* opens October 10, 2026.
5. This exhibition includes strobing lights; viewer discretion is advised.

♿ Family/all-gender restroom